

LAND OF PLOT NO.442 & 446

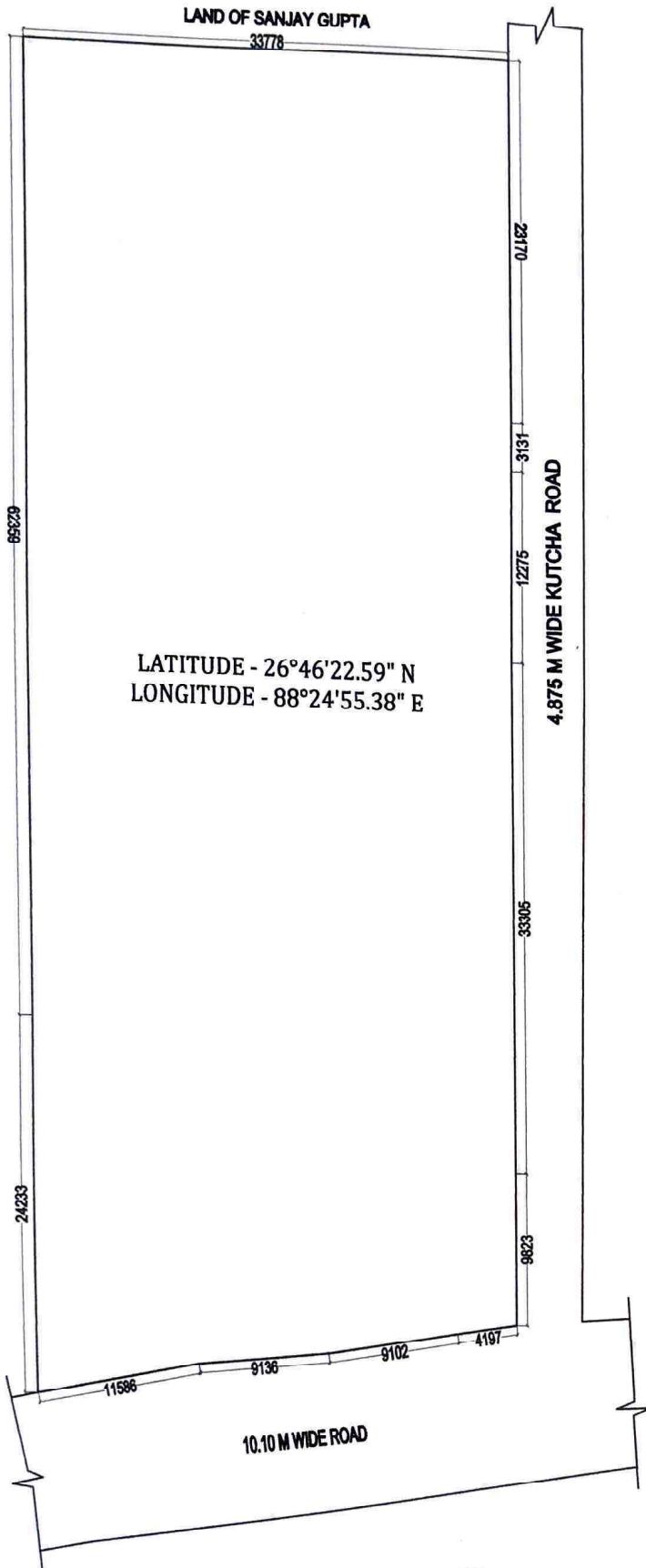

LATITUDE - 26°46'22.59" N  
LONGITUDE - 88°24'55.38" E

**SITE PLAN**



**PROJECT :**  
PROPOSED GROUND+ 6 STORIED  
RESIDENTIAL BUILDING.

**NAME OF THE OWNER :**  
LUNAWAT REALTY PRIVATE LIMITED.  
REPRESENTED BY ITS DIRECTOR  
SRI.BABULAL JAIN,  
S/O. I.T. PUNAM CHAND JAIN.

**LOCATION:**  
BABUBASA,P.S. MATIGARA, DIST.  
DARJEELING

**SCHEDULE OF LAND :**

MOUZA - MAHISHMARI;  
J.L NO. - 47;  
L.R. PLOT NO. - 440, 441,441/ 597,440/ 596  
R.S. PLOT NO. -211,212  
SHEET NO - 2(R.S)  
L.R KHATIAN NO. - 1202  
R.S KHATIAN NO. - 34  
P.S. - MATIGARA  
DIST. - DARJEELING

LATITUDE - 26°46'22.59" N  
LONGITUDE - 88°24'55.38" E

*Riya Biswas*  
RIYA BISWAS (B.Arch)  
CA/2019/112919

SIGNATURE OF ARCHITECT